

\* required information

**Section 1 of 21**

You can save the form at any time and resume it later. You do not need to be logged in when you resume.

System reference

Not Currently In Use

This is the unique reference for this application generated by the system.

Your reference

You can put what you want here to help you track applications if you make lots of them. It is passed to the authority.

Are you an agent acting on behalf of the applicant?

Yes  No

Put "no" if you are applying on your own behalf or on behalf of a business you own or work for.

**Applicant Details**

\* First name

Mehmet

\* Family name

Keso

\* E-mail

Main telephone number

Include country code.

Other telephone number

Indicate here if you would prefer not to be contacted by telephone

Are you:

Applying as a business or organisation, including as a sole trader  
 Applying as an individual

A sole trader is a business owned by one person without any special legal structure. Applying as an individual means you are applying so you can be employed, or for some other personal reason, such as following a hobby.

RECEIVED 18 JUL 2017

Continued from previous page...

Your Address

Address official correspondence should be sent to.

\* Building number or name [REDACTED]

\* Street [REDACTED]

District [REDACTED]

\* City or town London

County or administrative area [REDACTED]

\* Postcode [REDACTED]

\* Country United Kingdom

Section 2 of 21

PREMISES DETAILS

I/we, as named in section 1, apply for a premises licence under section 17 of the Licensing Act 2003 for the premises described in section 2 below (the premises) and I/we are making this application to you as the relevant licensing authority in accordance with section 12 of the Licensing Act 2003.

Premises Address

Are you able to provide a postal address, OS map reference or description of the premises?

- Address
- OS map reference
- Description

Postal Address Of Premises

Building number or name 278-280

Street Lower addescombe Road

District Croydon

City or town London

County or administrative area [REDACTED]

Postcode CRO 7AE

Country United Kingdom

Further Details

Telephone number [REDACTED]

Non-domestic rateable value of premises (£) 33,250

**Section 3 of 21**

**APPLICATION DETAILS**

In what capacity are you applying for the premises licence?

- An individual or individuals
- A limited company / limited liability partnership
- A partnership (other than limited liability)
- An unincorporated association
- Other (for example a statutory corporation)
- A recognised club
- A charity
- The proprietor of an educational establishment
- A health service body
- A person who is registered under part 2 of the Care Standards Act 2000 (c14) in respect of an independent hospital in Wales
- A person who is registered under Chapter 2 of Part 1 of the Health and Social Care Act 2008 in respect of the carrying on of a regulated activity (within the meaning of that Part) in an independent hospital in England
- The chief officer of police of a police force in England and Wales

**Confirm The Following**

- I am carrying on or proposing to carry on a business which involves the use of the premises for licensable activities
- I am making the application pursuant to a statutory function
- I am making the application pursuant to a function discharged by virtue of Her Majesty's prerogative

**Section 4 of 21**

**INDIVIDUAL APPLICANT DETAILS**

**Applicant Name**

Is the name the same as (or similar to) the details given in section one?

- Yes
- No

If "Yes" is selected you can re-use the details from section one, or amend them as required. Select "No" to enter a completely new set of details.

First name

Family name

Is the applicant 18 years of age or older?

- Yes
- No

Continued from previous page...

**Current Residential Address**

Is the address the same as (or similar to) the address given in section one?

Yes  No

If "Yes" is selected you can re-use the details from section one, or amend them as required. Select "No" to enter a completely new set of details.

Building number or name

Street

District

City or town

County or administrative area

Postcode

Country

**Applicant Contact Details**

Are the contact details the same as (or similar to) those given in section one?

Yes  No

If "Yes" is selected you can re-use the details from section one, or amend them as required. Select "No" to enter a completely new set of details.

E-mail

Telephone number

Other telephone number

\* Date of birth  /  /   
dd mm yyyy

\* Nationality  Documents that demonstrate entitlement to work in the UK

**Section 5 of 21**

**OPERATING SCHEDULE**

When do you want the premises licence to start?  /  /   
dd mm yyyy

If you wish the licence to be valid only for a limited period, when do you want it to end  /  /   
dd mm yyyy

Provide a general description of the premises

For example the type of premises, its general situation and layout and any other information which could be relevant to the licensing objectives. Where your application includes off-supplies of alcohol and you intend to provide a place for consumption of these off-supplies you must include a description of where the place will be and its proximity to the premises.

Continued from previous page...

See guidance on regulated entertainment

Will you be providing performances of dance?

Yes  No

**Section 13 of 21**

**PROVISION OF ANYTHING OF A SIMILAR DESCRIPTION TO LIVE MUSIC, RECORDED MUSIC OR PERFORMANCES OF DANCE**

See guidance on regulated entertainment

Will you be providing anything similar to live music, recorded music or performances of dance?

Yes  No

**Section 14 of 21**

**LATE NIGHT REFRESHMENT**

Will you be providing late night refreshment?

Yes  No

**Section 15 of 21**

**SUPPLY OF ALCOHOL**

Will you be selling or supplying alcohol?

Yes  No

**Standard Days And Timings**

MONDAY

Start

End

Start

End

Give timings in 24 hour clock. (e.g., 16:00) and only give details for the days of the week when you intend the premises to be used for the activity.

TUESDAY

Start

End

Start

End

WEDNESDAY

Start

End

Start

End

THURSDAY

Start

End

Start

End

FRIDAY

Start

End

Start

End

Continued from previous page...

SATURDAY

Start  End

Start  End

SUNDAY

Start  End

Start  End

Will the sale of alcohol be for consumption:

- On the premises     Off the premises     Both

If the sale of alcohol is for consumption on the premises select on, if the sale of alcohol is for consumption away from the premises select off. If the sale of alcohol is for consumption on the premises and away from the premises select both.

State any seasonal variations

For example (but not exclusively) where the activity will occur on additional days during the summer months.

N/A

Non-standard timings. Where the premises will be used for the supply of alcohol at different times from those listed in the column on the left, list below

For example (but not exclusively), where you wish the activity to go on longer on a particular day e.g. Christmas Eve.

N/A

State the name and details of the individual whom you wish to specify on the licence as premises supervisor

**Name**

First name

Family name

Date of birth  /  /

Continued from previous page...

Enter the contact's address

Building number or name

Street

District

City or town

County or administrative area

Postcode

Country

Personal Licence number (if known)

Issuing licensing authority (if known)

PROPOSED DESIGNATED PREMISES SUPERVISOR CONSENT

How will the consent form of the proposed designated premises supervisor be supplied to the authority?

- Electronically, by the proposed designated premises supervisor
- As an attachment to this application

Reference number for consent form (if known)

If the consent form is already submitted, ask the proposed designated premises supervisor for its 'system reference' or 'your reference'.

Section 16 of 21

ADULT ENTERTAINMENT

Highlight any adult entertainment or services, activities, or other entertainment or matters ancillary to the use of the premises that may give rise to concern in respect of children

Give information about anything intended to occur at the premises or ancillary to the use of the premises which may give rise to concern in respect of children, regardless of whether you intend children to have access to the premises, for example (but not exclusively) nudity or semi-nudity, films for restricted age groups etc gambling machines etc.

N/A

Section 17 of 21

HOURS PREMISES ARE OPEN TO THE PUBLIC

Standard Days And Timings

MONDAY

Start

End

Start

End

Give timings in 24 hour clock. (e.g., 16:00) and only give details for the days of the week when you intend the premises to be used for the activity.

Continued from previous page...

TUESDAY

Start  End

Start  End

WEDNESDAY

Start  End

Start  End

THURSDAY

Start  End

Start  End

FRIDAY

Start  End

Start  End

SATURDAY

Start  End

Start  End

SUNDAY

Start  End

Start  End

State any seasonal variations

For example (but not exclusively) where the activity will occur on additional days during the summer months.

N/A

Non standard timings. Where you intend to use the premises to be open to the members and guests at different times from those listed in the column on the left, list below

For example (but not exclusively), where you wish the activity to go on longer on a particular day e.g. Christmas Eve.

Empty box for non-standard timings.

Section 18 of 21

LICENSING OBJECTIVES

Describe the steps you intend to take to promote the four licensing objectives:

a) General - all four licensing objectives (b,c,d,e)



A1

*Continued from previous page...*

List here steps you will take to promote all four licensing objectives together.

The Standard Practices listed below will be maintained at all times. All reasonable steps will be taken to ensure that the premises will have a positive impact upon the local environment and it is resident at all times.

b) The prevention of crime and disorder

The applicant will take all reasonable steps to ensure that crime and disorder does not occur on the premises. Any incidences of a criminal nature that may occur on the premises will be reported to the police. CCTV system shall be installed and maintained inside and outside the premises.

c) Public safety

Appropriate fire safety procedures are in place including fire extinguishers (HRO and CO2), internally illuminated fire exit sign, a smoke detector and emergency lighting. All emergency exits will remain clearly marked at all times. Emergency escape routes will be kept free of obstruction at all times.

d) The prevention of public nuisance

All customers are asked to respect neighbours and leave quietly. Notice will be clearly and prominently displayed to remaining customers to leave quietly. Trade refuse agreement to be arranged and maintained at all times.

e) The protection of children from harm

The licensee and staff will ask persons who appear to be under the age of 18 or photographic ID such as proof of age cards, the connections card and citizen card, photographic driving licence or passport, an official identity card issued by HM forces or by EU country, bearing the photograph and date of birth of bearer. A register of refused sales shall be kept and maintained on the premises.

**Section 19 of 21**

**NOTES ON DEMONSTRATING ENTITLEMENT TO WORK IN THE UK**

A1

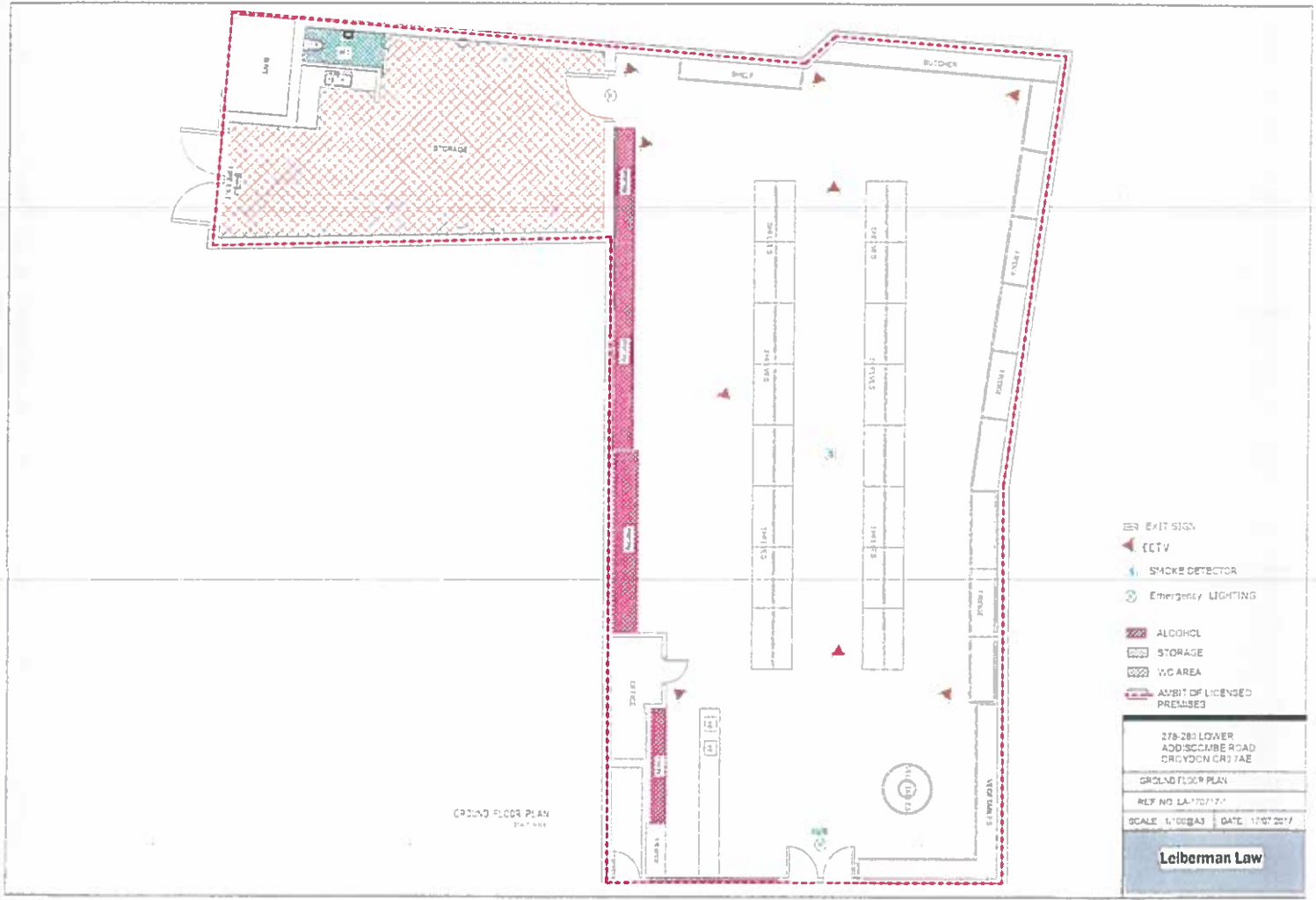

GROUND FLOOR PLAN  
DATE: 17/01/2017

- EXIT SIGN
- CCTV
- SMOKE DETECTOR
- EMERGENCY LIGHTING
- ALCOHOL
- STORAGE
- WC AREA
- AMBIT OF LICENSED PREMISES

278-281 LOWER  
ADDISCOMBER ROAD  
CROYDON CR2 7AE

GROUND FLOOR PLAN

REF NO LA-17017-1

SCALE 1/100 @ A3 DATE 17/01/2017

**Leiberman Law**

From: [REDACTED]  
Sent: 25 July 2017 20:57  
To: LICENSING  
Subject: Re: Licensing

Licence to sell alcohol in Lower Addiscombe Road.

I wish to put forward an objection to this application on the grounds that there are several outlets selling and serving alcohol in Lower Addiscombe Road another is not required. The council has a policy against anti social behaviour, alcohol fuels anti social behaviour. I live in Fernhurst Road and do not feel another outlet for alcohol is needed. There is already a deal of anti social behaviour in this area, the Council should not be encouraging this practice as it contravenes their policy.

Regards

[REDACTED]

● Fernhurst Road, Addiscombe, Croydon ● [REDACTED]

---

---

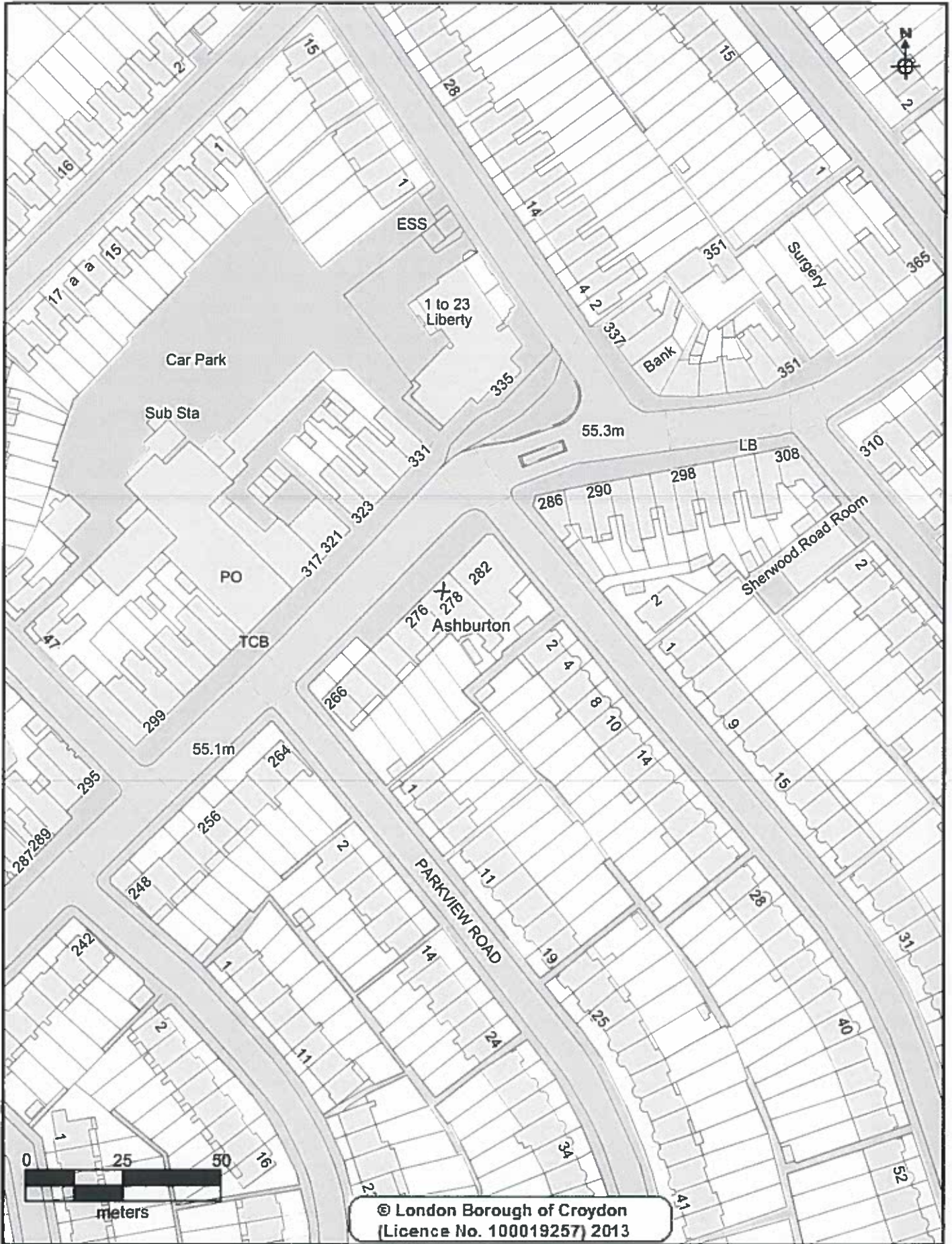

**CROYDON**  
[www.croydon.gov.uk](http://www.croydon.gov.uk)

Crown Copyright Ordnance Survey (License No: 100019257) 2011

**London Borough Croydon**

Scale 1:1250

24-Aug-2017



X = 278-280 LOWER ADDISCOMBE